

# Selas Superflame™ Burners

## Superflame™ 1000

Capacity: 1,000,000 Btu/hr (264kW)

Parameter	Burner Velocity		Superflame™ 1000
<b>Maximum Input, Btu/hr (kW)<sup>1</sup></b>	Medium and High Velocity		1,000,000 (264)
<b>Minimum Input, Btu/hr (kW)<sup>1</sup></b> <i>For lower inputs, contact Selas</i>	Medium and High Velocity		100,000 (26)
<b>Minimum Input Fixed Air, Btu/hr (kW)<sup>1</sup></b>	Medium and High Velocity		20,000 (5)
<b>Main Gas Inlet Pressure, "w.c. (mbar)</b>	High Velocity	Natural Gas	10 (25)
	Medium Velocity	Natural Gas	10 (25)
<b>Air Inlet Pressure, "w.c. (mbar)</b>	High Velocity	Natural Gas	15 (37)
	Medium Velocity	Natural Gas	11 (27)
<b>High Fire Visible Flame Length, inches (mm)</b>	High Velocity	Natural Gas	34 (864)
	Medium Velocity	Natural Gas	38 (965)
<b>Approximate Flame Velocity, ft/s (m/s)</b>	High Velocity		437 (133)
	Medium Velocity		284 (87)
<b>Maximum Combustion Air Temperature</b>	700°F (371°C)		
<b>Flame Detection</b>	Flame rods or UV scanners can be used with all combustors, any gaseous fuel <sup>2</sup> , and up to the maximum operating temperature.		
<b>Fuels</b>	Natural Gas <sup>2</sup>		

- All imperial inputs based upon gross calorific values (HHV). All metric inputs based upon net calorific values (LHV).
- Consult Selas for other fuels.
- Other notes:
  - All information is based on laboratory testing in neutral (0 "w.c., 0 mbar) pressure chamber. Different chamber conditions may affect emissions and pressure.
  - All information is based on standard outer tube design. Changes in combustor will alter performance and pressures.
  - All inputs based upon standard conditions; 1 atmosphere, 70°F (21°C).
  - Selas reserves the right to change the construction and/or configuration of our products at any time without being obliged to adjust earlier supplies accordingly.
  - Plumbing of air and gas will affect accuracy of orifice readings. All information is based on generally acceptable air and gas piping practices.



The Heat Technology Company™

# Selas Superflame™ Burners

## Performance Graphs, Imperial

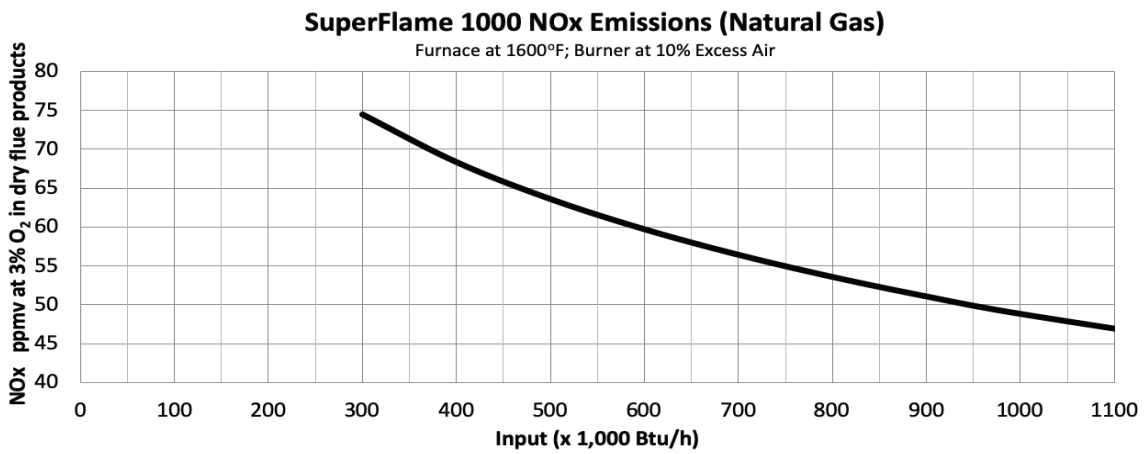
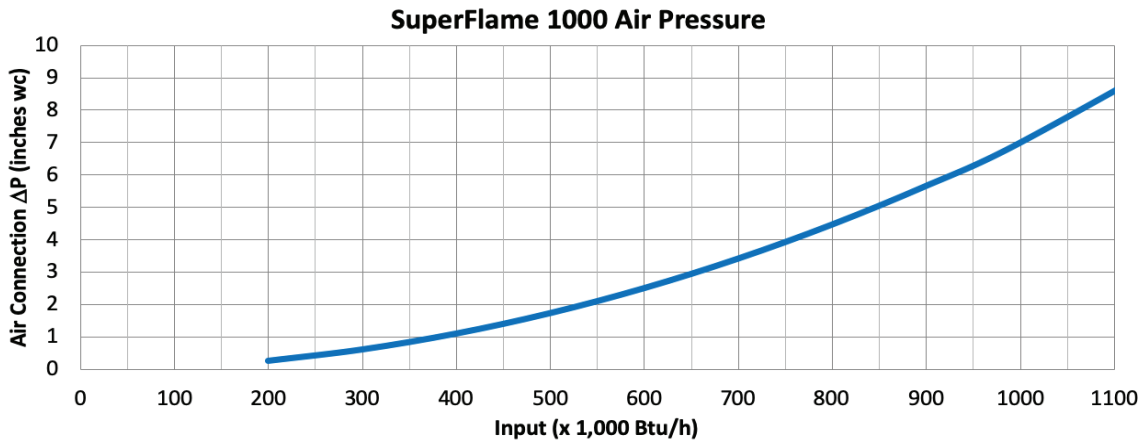
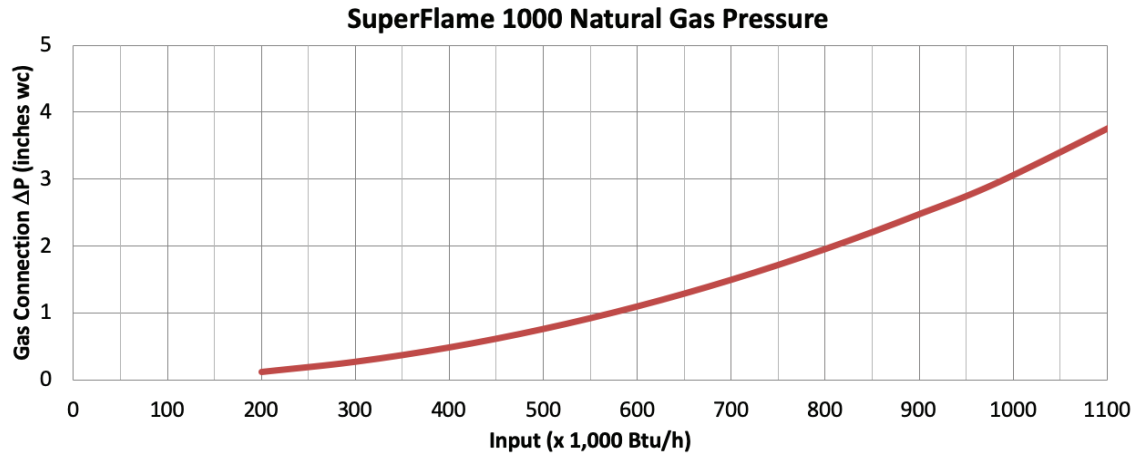

# Selas Superflame™ Burners

## Performance Graphs, Metric

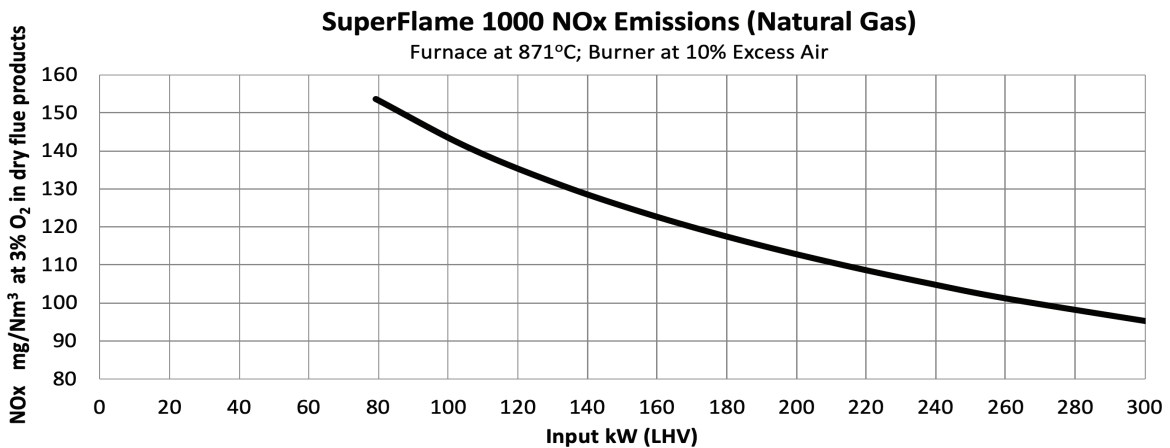
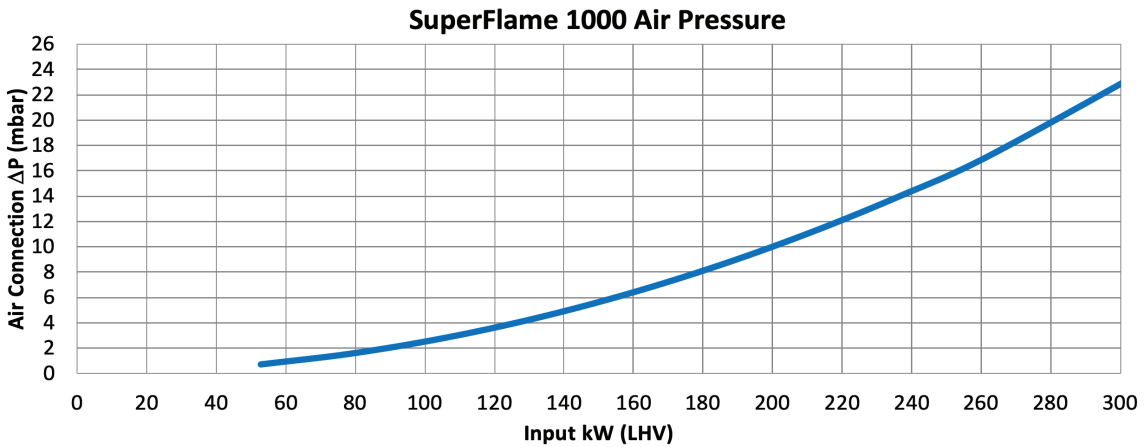
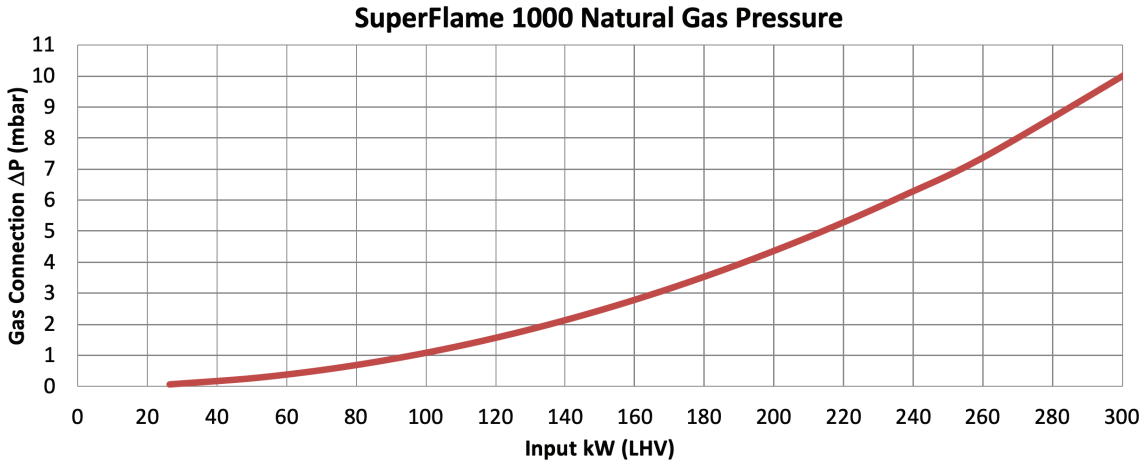

# Selas Superflame™ Burners

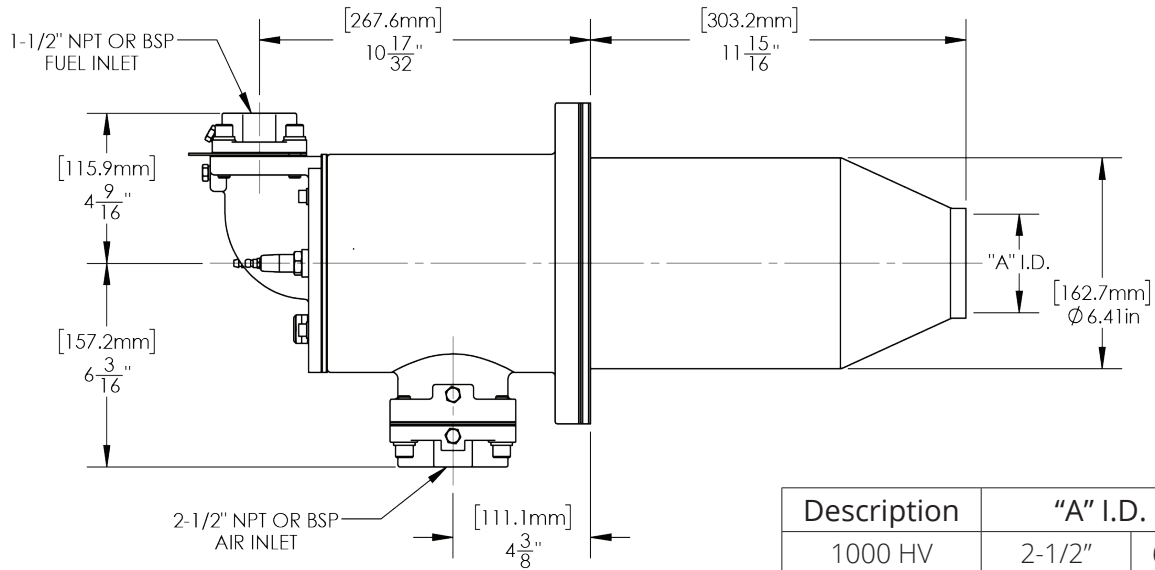

Description	"A" I.D. Ref	
1000 HV	2-1/2"	63.5mm
1000 MV	3"	76.2mm

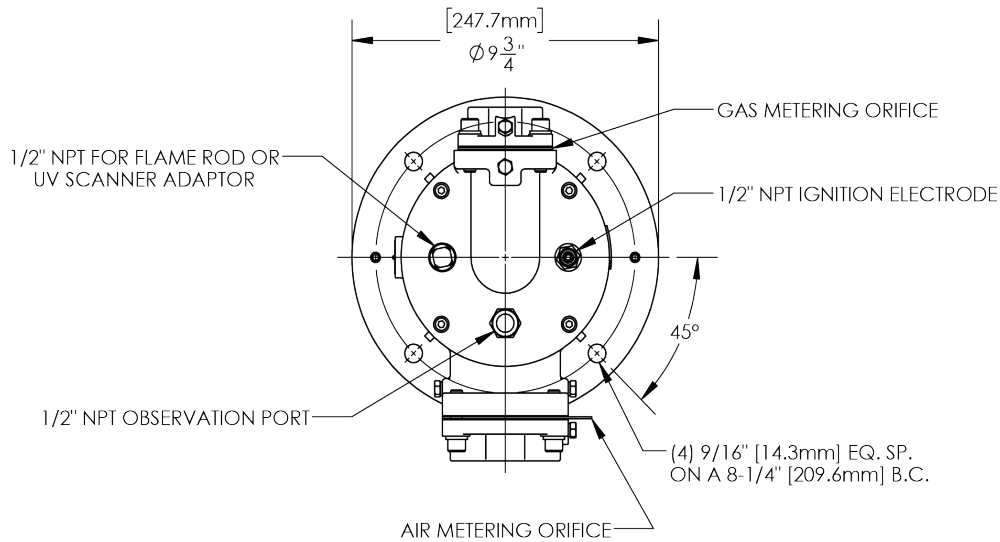

NOTE: Gas connection can be repositioned in 90° increments.